



FELLS

NEW FOREST PROPERTY



15 St. Ives End Lane, St. Ives

Ringwood



Guide Price £650,000

FELLS

NEW FOREST PROPERTY



15 St. Ives End Lane

St. Ives, Ringwood

Immaculate three/four double bedroom bungalow |
Built in 2002 by Raymond Brown | Approx 0.21 acre
plot | Spacious living areas | Double garage |
Beautiful gardens | Charming courtyard area | Ideal
indoor-outdoor living | Convenient to local
amenities, schools, major transport links.
Council Tax band: F

Tenure: Freehold

EPC Energy Efficiency Rating: D

EPC Environmental Impact Rating: D

- Detached Double Garage
- Approximately 0.21 Acre Plot
- Charming Front Courtyard
- Immaculately Presented Throughout
- Potential Four Double Bedrooms
- Beautiful West Facing Rear Garden
- Master Bedroom With En-Suite
- Built in 2002 By Raymond Brown



FELLS

NEW FOREST PROPERTY



Note: Measurements were not taken by LJT Surveying and we cannot guarantee their accuracy.

Ground Floor

Approx. 133.4 sq. metres (1436.4 sq. feet)

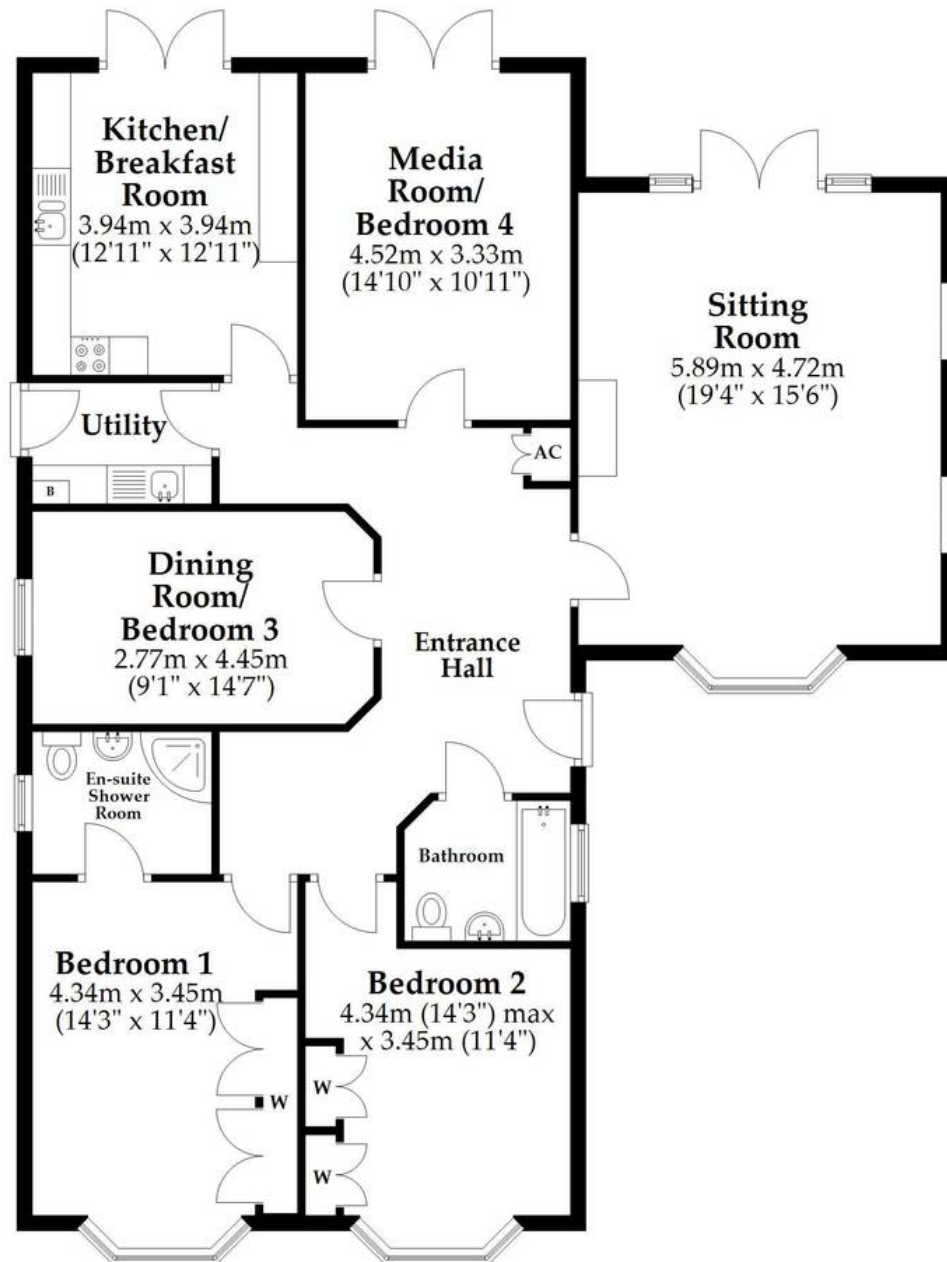

Garage

Approx. 28.1 sq. metres (302.4 sq. feet)

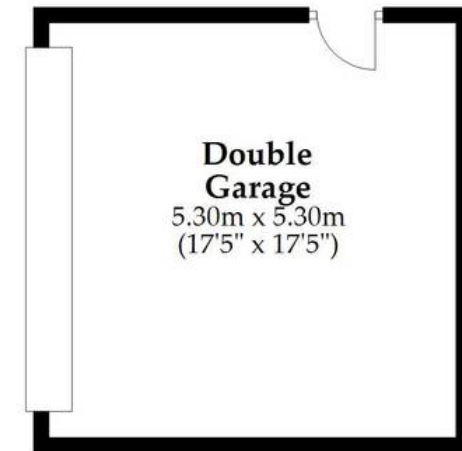

Total area: approx. 161.5 sq. metres (1738.8 sq. feet)

This plan is not to scale and it is for general guidance only. LJT Surveying Ltd Ringwood



You can include any text here. The text can be modified upon generating your brochure.

